

# THE WEEKLY



Issue 30, 30 October 2015

## Inside this issue

- \* From the Head of Primary
- \* SPW Foundation
- \* Sports News
- \* Old Logo
- \* Uniform Shop
- \* Canteen
- \* Chaplain's Chat
- \* Blessing of the Pets
- \* SRC Donations to SA Dog Rescue
- \* Extra-Curricular Photos
- \* Lamont Book Club
- \* PFA News
- \* Thought for the Week
- \* Qkr! App Tip
- \* Extra-Curricular Photographs Information
- \* The Week Ahead

## From the Head of Primary

What an amazing week it's been for our 6/7 Centre students. Wednesday saw our Year 7s engage our student community in the annual Jumble Sale. While learning about marketing and economics, our Year 7 students planned and reflected on their business acumen. While immediate learning is around economics, I thoroughly enjoy the Jumble Sale as it's an opportunity for our students to once again think of others. Our Year 7 children considered who they felt would benefit from any money raised. They selected the Butterfly Foundation for Eating Disorders. The morning was a wonderful opportunity for students to purchase a range of items, and for me to enjoy ice-cream before Recess.

There was enthusiasm aplenty on Thursday morning during a delightful Chapel service which was written and presented by our Year 6 students. When we have boys and girls signing a cappella, instrumentalists joining together, and dancing in the aisles something is going right.

I spent some time this morning in the new Design and Technologies Suite amazed by our Year 6 students who were completely engaged in the current real life task, the production of tables they have designed, through consultation, for our Early Learning Centre. The teamwork, problem solving and skill development was brilliant to witness.

The opportunities our students are faced with and, to their credit, are willing to grab with both hands, almost makes me want to be 12 again. Almost.

Have a wonderful weekend.

**Amanda Kelly**

## SPW Foundation

With perfect weather predicted for Sunday, we are going to be in for a very special time at The Long Lunch. Thank you to all who have supported this event by buying tickets and also a big thank you to our amazing donors for contributing such a diverse range of items for the Auction.

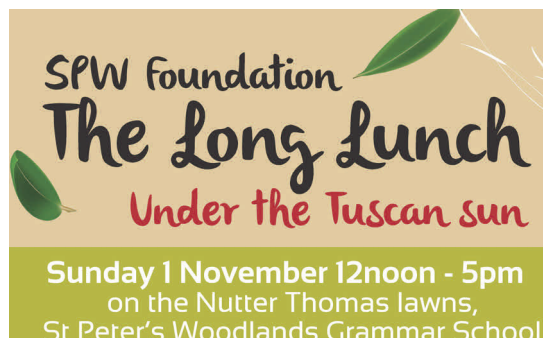

SPW Foundation  
**The Long Lunch**  
Under the Tuscan sun

Sunday 1 November 12noon - 5pm  
on the Nutter Thomas lawns,  
St Peter's Woodlands Grammar School

Join us on [Facebook](#)  
and [Twitter](#) (or email)



**Karen Schaumloffel**  
SPW Foundation

Huw Bowen  
[hbowen@spw.sa.edu.au](mailto:hbowen@spw.sa.edu.au)  
 0413 244 539

## Sports News

### SPORTS RESULTS

#### VOLLEYBALL

SPW Year 4 Girls Teal	47 points		
Paringa PS	30 points	SPW Black	0 points
SPW Orange	44 points	SPW Magenta	40 points

### SPORTS RESULTS

A reminder that it is an expectation a team member will share the team's result at Assembly. Please ensure your coach is aware and has 'green' forms. They can be collected anytime from Mr Bowen.

### SPORTS ASSEMBLY

Please note the following date in your diaries for the Term 4 Sports Assembly, Friday 4 December (Week 8) 11.30am -12.30pm. Year 4 – 7, special guest Kane Cornes.

### SAPSASA KNOCK OUT TENNIS

Our girls' and boys' teams were unfortunately both defeated in Round 2 of the competition this week. They were thoroughly competitive and represented SPW's first participation in this competition.

### JUNIOR PRIMARY SPORTS DAY—FRIDAY 13 NOVEMBER

Only 14 sleeps to go.

### BASKETBALL

Please regularly check the basketball fixture website. It is often updated without SPW being notified. [http://www.foxsportspulse.com/assoc\\_page.cgi?c=1-4398-0-0-0&a=COMPS](http://www.foxsportspulse.com/assoc_page.cgi?c=1-4398-0-0-0&a=COMPS)

Better still, download the Skoolbag app onto your phone, where you will be able to find all the information and links required.

**Huw Bowen**  
**Sports & PE Coordinator**

## Old Logo

Just a reminder that clothing with the 'old logo' will be able to be worn until the end of 2015. After that time it will no longer be able to be worn. The new logo has been in circulation since January 2013, therefore has allowed for a three year transition period from the old to the new. There are two exceptions; the old style Windcheater top and the old style SPW representative top—both of these can be worn until December 2016.

## Uniform Shop

Wondering what to do with your old logo items? Feel like they are a too good to throw away? I will be collecting them for South Pacific School Aid. The garments will be sent overseas and put to good use. Please donate freshly laundered items to me and I will organise for them to be delivered to those who can use them. Items can be placed in the bin outside the Uniform Shop from 8.15am until 4.00pm, Monday to Thursday.

**Tiona Ryan**  
**Uniform Shop Manager**

## Canteen

The Halloween donuts were very popular this week. Thank you to everyone who supported this special offer via their Qkr! app.

**Rosy Elphick**  
**Canteen Manager**

## Chaplain's Chat

### Expressing Yourself in Art

Well done to the Year 6 students for their chapel service about Faith in Art. Their exploration of the importance of artistic expression through music, dance, painting, sculpture, poetry and other art forms connects with their current unit of study on art. Their excellent organization and leadership in the service bodes well for their roles as Year 7 leaders in 2016.

### Thank You to Staff

Having returned from some Long Service Leave may I sincerely thank the staff who led the Chapel Service in Week 1. I have heard nothing but rave reports about the service. What a great team we have working here!



### Blessing of the Pets

Our annual pet blessing service will be held **next Thursday 5 November at 8.45am on Braested Oval**. SPW students are welcome to bring their pets along for this special service. All pets need to be suitably restrained or contained for the occasion. Children who are unable to bring pets are welcome to bring photos of their pets for blessing. Children who don't have pets are welcome to bring a stuffed toy to the service.

We encourage Parents and special friends to attend and participate in this service too and to safely take their pets home afterwards. Children will sit on the grass in class groups in a large semi circle around the oval and parents and special friends are invited to stand behind their child's class. At the conclusion of the service Fr Andrew will circulate the crowd in order to bless pets individually.

I am sure many are looking forward to this favourite school celebration with all the furry, scaled and feathered members of our SPW community.

**Fr Andrew Minterm**  
School Chaplain

## SRC—Donations to SA Dog Rescue

This year as part of Blessing of the Pets the SRC decided it would be a wonderful opportunity to help an Animal Shelter and give some helpful items and gifts to cats and dogs that are waiting for a loving family to go to. The Dog shelter we have decided to donate to is [SA Dog Rescue](#).

SA Dog Rescue is a not-for-profit organisation, supported by volunteers in SA, dedicated to saving pets from being wrongly treated, and finding them a new home where they can live with love and care. SA Dog Rescue not only cares for dogs and cats; amazingly they also help rescue horses, goats, sheep, reptiles, camels and native animals.

How can you help?

On **Thursday 5 November** there will be a food and bedding collection point on Braested Oval where donations for SA Dog Rescue will be collected. Suggested donations to SA Dog Rescue may include canned dog food, canned cat food, dry dog or cat biscuits, or bedding.

Thank you for your ongoing support of the SRC.



### Extra-Curricular Photographs

Term 4 Extra-curricular photographs are scheduled for next week, **Friday 6 November**. Please note that groups on the list who wear school uniform are to wear the summer uniform. We remind families that students are to be in the correct uniform at the time the photograph is scheduled, or they will not be able to be in the photo. Please help us to ensure our students look fantastic in their photos.

**Simon Theel**  
Deputy Principal

### Lamont Book Club

In 2015 we tried Lamont Book Club instead of Scholastic. The students have let us know they do not like the selections offered, and as there have been other problems with it as well, we will not be continuing with it in 2016.

In Issue 7 (the latest issue) there are 2 pages of books at the end of each brochure – one for Young Adult and Teen readers, and one for Adults. In my opinion, none of these books are at all suitable for our students (even though many of our students are teenagers), and if you do consider buying any of those titles they would be suited to late teens/adults only.

Please feel free to discuss any of the books with us in the Library. We are happy to listen.

**Jenny Richardson**  
Librarian



### PFA News

#### **MONDAY BARBECUES**

The Monday after school barbecues continue and this term we are asking for help from across the school community. This coming Monday, 2 November, we are asking for help from Year 5 families. All sausages, bread, drinks and sauce will be at the shelter shed. All we ask is for 3-4 helpers from 2.30pm until around 3.45-4.00pm. Please let Jane know if you are available to help, mobile 0402 235 573. Thank you.

#### **PFA AGM**

Thank you to those who attended the AGM and Thank You evening on Wednesday. The PFA Executive remains the same as for 2016 except for the departure of Jane Tuohy as Co-President. Thank you Jane for all your hard work during your time in this important position. We have really appreciated the continued support of the school community and hope to see many new faces attending in 2016.

#### **HALLOWEEN DISCO**

Thank you to all who have supported the Disco. We have had over 370 children book for this event which is a fantastic response.

A big THANK YOU to all the parent volunteers who will be assisting in supervision on the night, and to the Year 2 Class Representatives for their involvement in the organisation, with a special mention to Kylie Morrissey, Jane Mudie and Sheree Guppy for looking after the extra little details. We hope the students enjoy the evening. If you have any feedback/ideas on how to improve this event for future years, please email the PFA.

#### **CHRISTMAS RAFFLE**

The ever popular Christmas Raffle is nearly upon us. Please watch for details about purchasing tickets as they will be coming home very soon. Only 8 weeks until Christmas.

#### **CONTACT**

[pfa@spw.sa.edu.au](mailto:pfa@spw.sa.edu.au)



## Thought for the Week This Week's To-Do List

1. Practise kindness
2. Let go of what I can't control
3. Count my blessings
4. Instil calmness around me
5. Share my light with others

## Qkr! App Tip

If you have an iPhone 5s or newer, or an iPad that supports Touch ID, the Qkr (pronounced 'quicker') app can now also use these same credentials to ensure you never forget your password again. Enabling Touch ID on an Apple device does not share your fingerprint data with MasterCard, as it remains stored securely within the device itself.

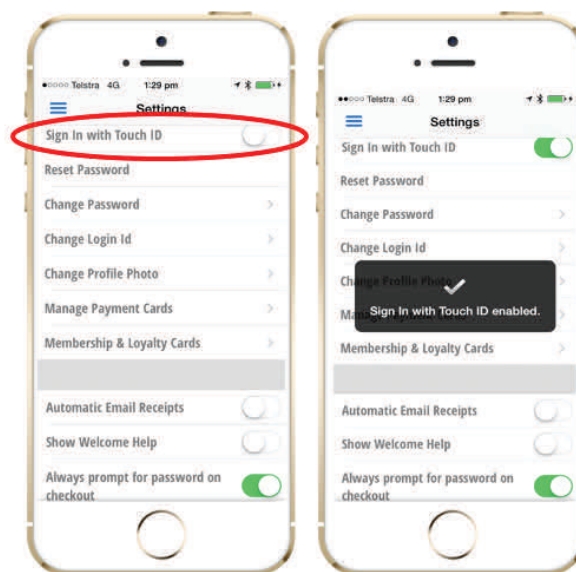

# PHOTOGRAPHS

## Extra- and Co-Curricular Activities



### Session 2: Friday 6 November (Term 4)

**Please note change: SUMMER uniform  
(groups affected are highlighted in below table)**

The following groups will be photographed during the day.  
Please ensure the student is wearing the full, correct uniform as listed (including footwear).

Students not in correct uniform will not be photographed.

(Please ensure students do not have to borrow clothes  
from other students being photographed.)

Note: this may not be the order in which photographs are taken

Group/Team	Uniform and Other Items
SAPSASA State Representatives (ie students who have represented at State Level in any of the following: Athletics (including SA State reps), Cross-Country, Hockey, Soccer, Swimming)	Full SUMMER uniform, including <u>own</u> jumper/vest  If medals won at the event, please bring to photo
SAPSASA District Athletics Team	SPW representative sports uniform
SAPSASA State Knockout Tennis Squad (Boys & Girls)	SPW representative sports uniform
SAPSASA Goalball Squad	SPW PE sports uniform
SAPSASA District Touch Teams (Boys and Girls)	SPW representative sports uniform
Basketball: Year-Level SPW Teams	SPW Basketball uniform (singlets, shorts, white socks, runners)
SAPSASA Basketball Squads (Boys and Girls)	SPW Basketball uniform (singlets, shorts, white socks, runners)
Cricket: Year-Level SPW Teams	SPW Cricket whites (including white runners)
SAPSASA District Cricket Team	SPW Cricket whites (including white runners)
Volleyball: Year-Level SPW Teams	SPW Playing uniform including correct footwear and socks
Soccer: (re-shoot of shots taken in Term 2) Senior Boys Team Senior Girls Team	SPW soccer top, black sports shorts, royal blue soccer socks and boots.
Soccer: SAPSASA State Knockout Squad	SPW representative sports uniform, including shorts, socks, and boots.
Tournament of Minds	Full SUMMER uniform, including <u>own</u> jumper/vest
Oliphant Science	Full SUMMER uniform, including <u>own</u> jumper/vest
IPSHA Poetry Recital Finalists	Full SUMMER uniform, including <u>own</u> jumper/vest
JLTA Japanese Quiz Team	Full SUMMER uniform, including <u>own</u> jumper/vest
SRC Representatives Semester 2	Full SUMMER uniform, including <u>own</u> jumper/vest

# The Week Ahead



2015 Term 4 Week 4

Monday 2—Friday 6 November

Contact Us

	Monday	Tuesday	Wednesday	Thursday	Friday
Canteen	NO HELP REQUIRED	HELP REQUIRED	JULIA STONE	HELP REQUIRED	JO MINTERN
School	<ul style="list-style-type: none"> <li>* <b>Uniform Shop Hours</b> ◇ 8.15am—9.00am ◇ 2.30pm—4.00pm</li> <li>* <b>ELC Photos</b>—9.00am</li> </ul>	<ul style="list-style-type: none"> <li>* <b>Uniform Shop Hours</b> ◇ 8.15am—9.00am ◇ 2.30pm—4.00pm</li> <li>* <b>ELC Photos</b>—9.00am</li> <li>* <b>Whole School Assembly</b> (Chapel) - 2.30pm</li> </ul>	<ul style="list-style-type: none"> <li>* <b>Uniform Shop Hours</b> ◇ 8.15am—9.00am ◇ 2.30pm—4.00pm</li> <li>* <b>ELC Photos</b>—9.00am</li> <li>* <b>ELC/Yr Reception/Year 1 Assembly, led by Year 1</b> (Chapel) - 2.30pm</li> </ul>	<ul style="list-style-type: none"> <li>* <b>Uniform Shop Hours</b> ◇ 8.15am—9.00am ◇ 2.30pm—4.00pm</li> <li>* <b>Blessing of the Pets</b>— (Braested Oval) 8.45am </li> <li>* <b>ELC Photos</b>—9.00am</li> <li>* <b>SAPSASA State Tennis &amp; Cricket Carnival</b></li> </ul>	<ul style="list-style-type: none"> <li>* <b>ELC Photos</b>—9.00am</li> <li>* <b>Extra &amp; Co-Curricular Photos</b> (Baddams Hall)</li> </ul>
Extra & Co Curricular	<ul style="list-style-type: none"> <li>* <b>Games Club R-7</b>—12.50-1.30pm (The Hub)</li> <li>* <b>MP &amp; JP Activities</b></li> <li>* <b>UP Sport</b>, 3.30-4.30pm</li> <li>* <b>Year 7 Basketball Matches</b> (Marion/Pasadena) after school</li> </ul>	<ul style="list-style-type: none"> <li>* <b>SPW Band</b>—8.15-8.55am (Music Suite)</li> <li>* <b>Chapel Choir</b>—12.50-1.30pm (Chapel)</li> <li>* <b>Junior Choir</b>—12.50-1.30pm (Music Suite)</li> <li>* <b>Knitting Club</b>—12.50-1.30pm (The Hub)</li> <li>* <b>Lego Technic/Construction Club (Yrs 4-7)</b> -12.50-1.30pm (The Hub)</li> <li>* <b>Yoga Yrs 3-7</b>—12.50-1.30pm (Baddams Hall)</li> <li>* <b>Arts Rehearsals</b>—3.30-5.00pm (Chapel &amp; Music Suite)</li> <li>* <b>Year 5 Basketball Matches</b> (Marion/Pasadena), after school</li> </ul>	<ul style="list-style-type: none"> <li>* <b>Run Club</b>—8.15-8.55am (McKenzie Oval)</li> <li>* <b>Chess Club</b>—12.50-1.30pm (The Hub)</li> <li>* <b>Show Choir</b>—12.50-1.30pm (Music Suite)</li> <li>* <b>Year 3/4 Basketball Matches</b> (Marion / Pasadena) , after school</li> </ul>	<ul style="list-style-type: none"> <li>* <b>Chapel Choir &amp; Band</b>—8.15-8.45am (Chapel)</li> <li>* <b>Comic Writing Club</b> - 12.50-1.30pm (The Hub)</li> <li>* <b>Flute Ensemble</b>—12.50-1.30pm (Chapel)</li> <li>* <b>Lego Construction Club (Rec-Yr7)</b>—12.50-1.30pm (The Hub)</li> <li>* <b>Percussion Ensemble</b>—12.50-1.30pm (Music Suite)</li> <li>* <b>Year 6 Basketball Matches</b> (Marion / Pasadena) after school</li> <li>* <b>Year 4 C Cricket Matches</b> 4.00pm (various)</li> </ul>	<ul style="list-style-type: none"> <li>* <b>Year 6-7 Co-curricular Activities</b> 8.15-8.55am (Various)</li> <li>* <b>Games Club</b>—12.50-1.30pm (The Hub)</li> <li>* <b>Sports Practices</b>—12.50-1.30pm (Mackenzie, Baddams, Courts)</li> <li>* <b>SRC Meeting, Reception to Year 3</b>—2.30pm (Library Seminar Room)</li> <li>* <b>Years 4-7 Volleyball Matches</b> (Brighton Secondary) after school</li> </ul>
PFA	<b>PFA Sports BBQ</b> , 3.15-4.00pm				

**Front Office**  
8295 4317  
[administration@spw.sa.edu.au](mailto:administration@spw.sa.edu.au)

**Student Absentees**  
7221 6221  
[absentees@spw.sa.edu.au](mailto:absentees@spw.sa.edu.au)

**OSHC**  
0411 298 878 Camp Australia

**Finance Office**  
7221 6229  
[finance@spw.sa.edu.au](mailto:finance@spw.sa.edu.au)

**Canteen**  
7221 6216  
Rosy Elphick, Manager  
[relphick@spw.sa.edu.au](mailto:relphick@spw.sa.edu.au)

**Website**  
[spw.sa.edu.au](http://spw.sa.edu.au)

St Peter's Woodlands is an IB World School accredited in the International Baccalaureate Primary Years Program (PYP)



St Peter's Woodlands Grammar School Inc  
39 Partridge Street Glenelg SA 5045  
A Co-educational Anglican Primary School